

There must be no deviation from these details without written agreement from Straw Works Ltd.

Strawbale wall construction: 460mm bales trimmed either side to 450mm with lime render externally & lime or clay internally. Render/plaster coats should be minimum 30 mm thick in 2 to 4 layers depending on required finish.

All board materials to be formaldehyde free; all timber products to be FSC certified

All structural roof timber specifications subject to confirmation by manufacturer or manufacturer's design

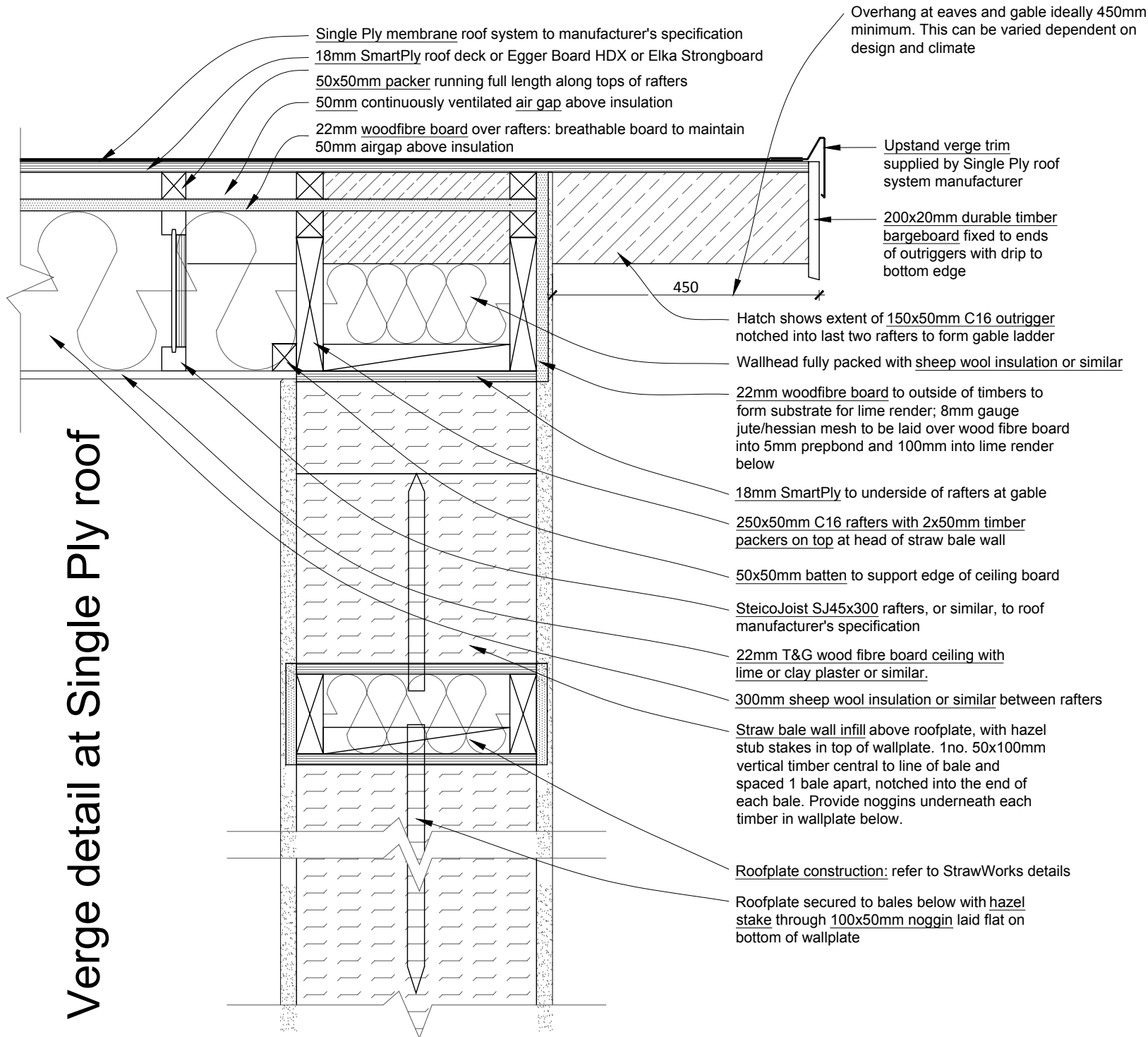

Verge detail at Single Ply roof

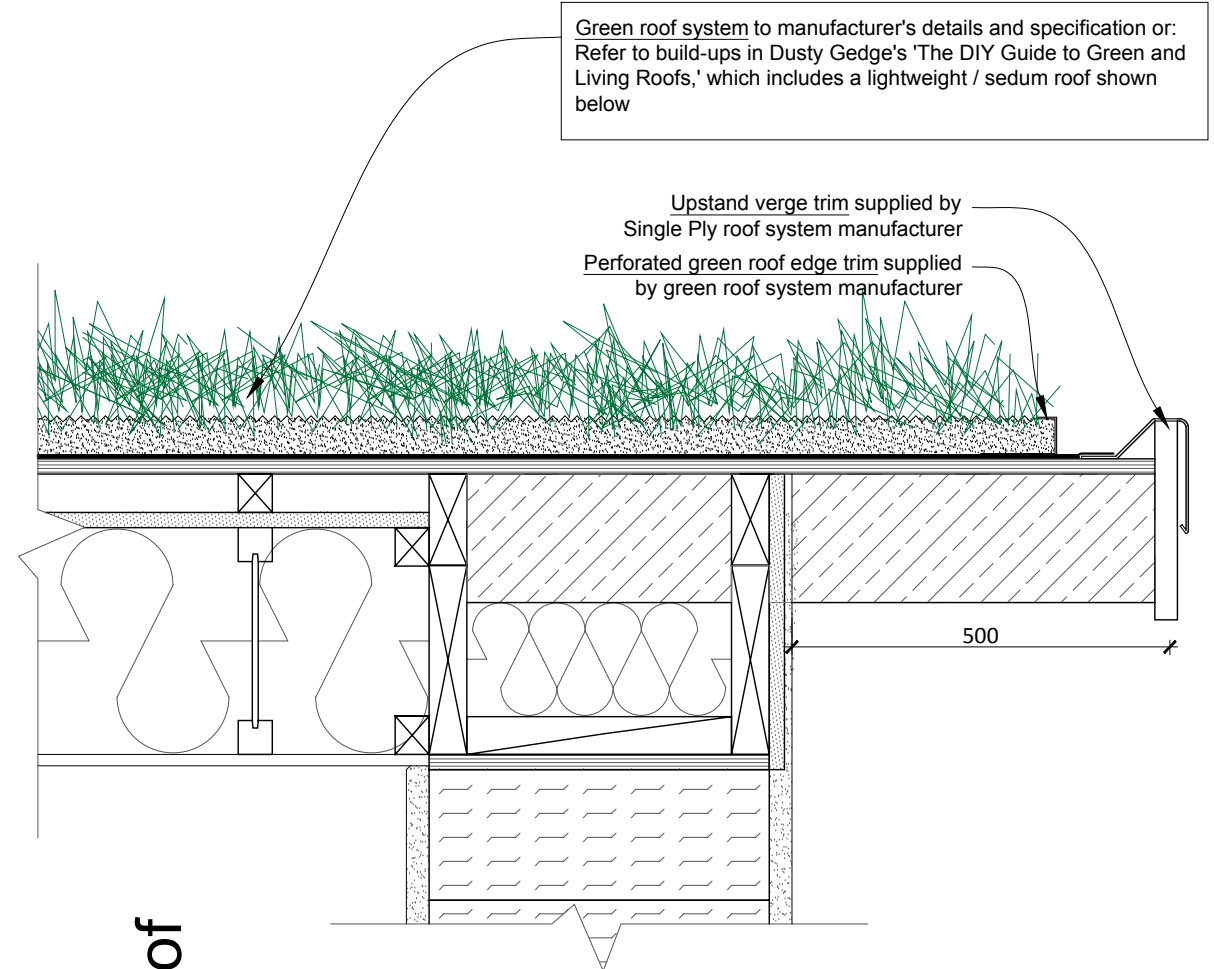

Verge detail at Sedum roof

Alternative Detail based on Dusty Gedge's 'The DIY Guide to Green and Living Roofs'

