

There must be no deviation from these details without written agreement from Straw Works Ltd.

Strawbale wall construction: 460mm bales trimmed either side to 450mm with lime render externally & lime or clay internally. Render/plaster coats should be minimum 30 mm thick in 2 to 4 layers depending on required finish.

All board materials to be formaldehyde free; all timber products to be FSC certified

All structural roof timber specifications subject to confirmation by manufacturer to manufacturer's design

Note: No need for vapour permeable membrane as woodfibre board performs this function.

100x20mm durable timber cover board between rafters to maintain 20mm continuous gap for eaves ventilation; 4mm gauge insect mesh to opening

Green roof held 150mm back from edge of roof with perforated edge trim supplied by green roof manufacturer or use galvanised metal mesh.

Preformed edge trim fitted to Single Ply roof manufacturer's details

100x50 C24 durable timber rafter extension peices fixed to I joists.

Overhang at eaves and gable ideally 450mm minimum. This can be varied dependent on design and climate

Green roof system to manufacturer's details and specification or: Refer to build-ups in Dusty Gedge's 'The DIY Guide to Green and Living Roofs,' which includes a lightweight / sedum roof shown to the right

UV stable single ply roof membrane EPDM or similar approved

18mm SmartPly, Egger HDX board or Elka strongboard roof deck

50mm battens to provide ventilation above insulation

22mm t&g woodfibre sarking board above rafters: breathable board to maintain 50mm airgap above insulation

Rafters: 300dp engineered timber I joists to roof manufacturer's specification

Continuous line of noggins between rafters

300mm sheep wool insulation between rafters or similar natural quilted insulation

T&G wood fibre board ceiling with clay or lime plaster

Timber batten to support woodfibre board

Angled timber block to bring roof load onto centreline of wall rafters to be fixed with proprietary angle brackets, or nailed to manufacturers specifications

Roofplate construction: refer to StrawWorks details

Roofplate secured to bales below with hazel stake through 100x50mm noggin laid flat on bottom of box ring beam (unless roof is built first)

Straw bale wall construction

Alternative Detail

based on Dusty Gedge's 'The DIY Guide to Green and Living Roofs'

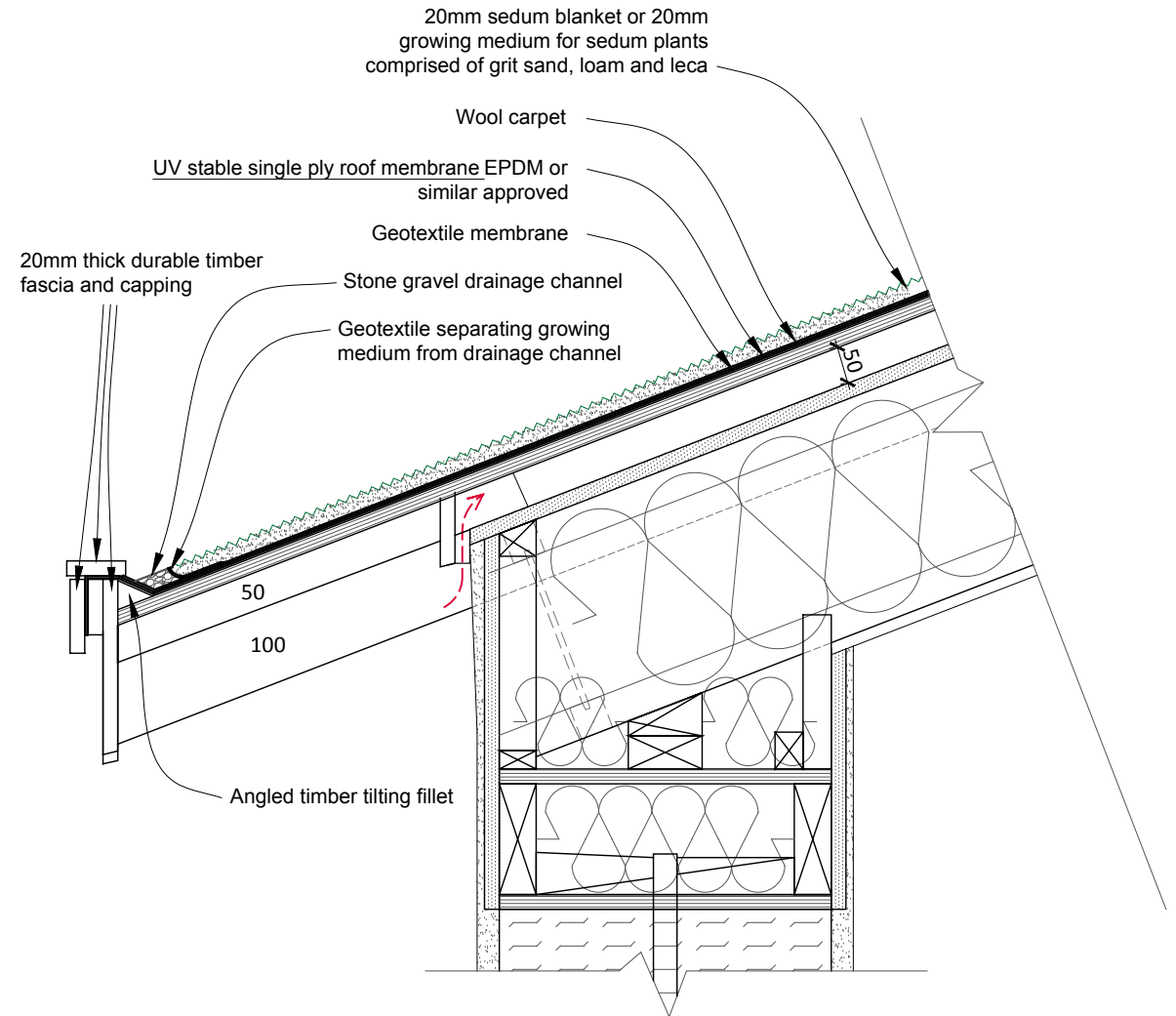

Eaves detail at Sedum roof